

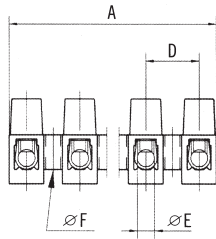

CTSN Series

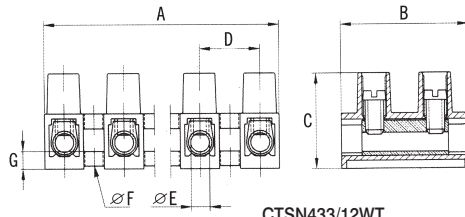

CTSN431/12W  
CTSN433/12W  
CTSN434/12W  
CTSN435/12W  
CTSN438/12W



CTSN433/12WT

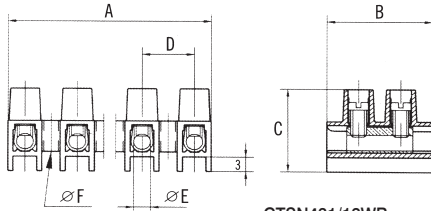

CTSN431/12WR  
CTSN433/12WR  
CTSN434/12WR  
CTSN435/12WR

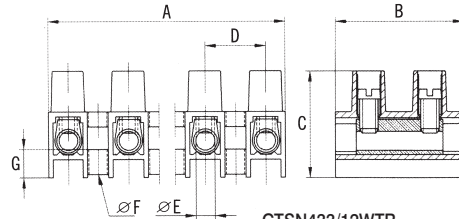

CTSN433/12WTR

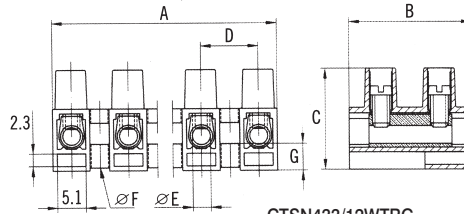

CTSN433/12WTRG

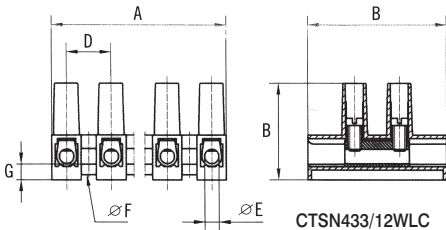

CTSN433/12WLC

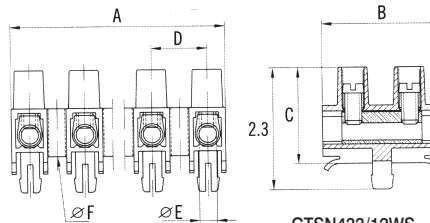

CTSN433/12WS

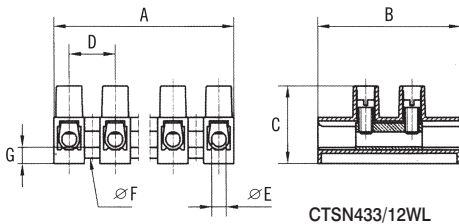

CTSN433/12WL

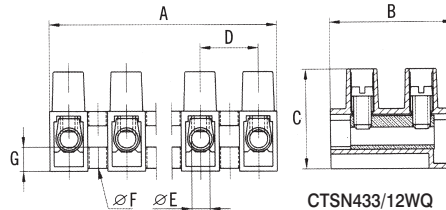

CTSN433/12WQ

Raised base types – provide increased isolation.

Type No.	Wire Protector	Cable acceptance	Length A (mm) (mm)	Width B (mm)	Height C (mm)	Fixing holes (mm)	Insert diameter	Fixing hole pitch (mm)	Max voltage (V)	Max current (A)
CTSN431/12WR	No	4.0	94	18	17.2	2.75	3.2	8	750	32
CTSN431/12R	Yes	2.5	94	18	17.2	2.75	3.2	8	750	32
CTSN433/12WR	No	6.0	116	21	17.8	3.1	3.5	10	750	41
CTSN433/12R	Yes	4.0	116	21	17.8	3.1	3.5	10	750	32
CTSN434/12WR	No	10.0	140	23	20.5	3.3	4.4	12	750	57
CTSN434/12R	Yes	6.0	140	23	20.5	3.3	4.4	12	750	41
CTSN435/12WR	No	16.0	166	29	25.8	3.4	6.0	14	750	76
CTSN435/12R	Yes	10.0	166	29	25.8	3.4	6.1	14	750	57

**Special types**

- CTSN433/12LC larger isolating surface per pole and screw tower Complies with EN60598/1 4.7 and 11.2
- CTSN433/12L larger isolating surface per pole (750V, test voltage 3,000V) Complies with EN60598/1 4.7 and 11.2
- CTSN433/12T fast fixing hole between poles
- CTSN433/12TR fast fixing hole between poles and raised base
- CTSN433/12TRG fast fixing hole between poles, raised base and socket in the base
- CTSN433/12S fixing pin (in any required position, maximum 8 pins)
- CTSN433/12Q fixing hole between poles and wide base terminal connection

Type No.	Size	Wire Protector	Cable acceptance (mm)	Length A (mm)	Width B (mm)	Height C (mm)	Fixing holes (mm)	Insert diameter (mm)	Max current (A)
CTSN433/12WLC	10mm/10A	No	4.0	117	31	21.5	3.1	3.5	41
CTSN433/12LC	10mm/10A	Yes	2.5	117	31	21.5	3.1	3.5	32
CTSN433/12WL	10mm/10A	No	4.0	117	31	16.8	3.1	3.5	41
CTSN433/12L	10mm/10A	Yes	2.5	117	31	16.8	3.1	3.5	32
CTSN433/12WT	10mm/10A	No	4.0	116	21	16	3.1	3.5	41
CTSN433/12T	10mm/10A	Yes	2.5	116	21	16	3.1	3.5	32
CTSN433/12WTR	10mm/10A	No	4.0	116	21	17.8	3.1	3.5	41
CTSN433/12TR	10mm/10A	Yes	2.5	116	21	17.8	3.1	3.5	32
CTSN433/12WTRG	10mm/10A	No	4.0	116	21	17.6	3.1	3.5	41
CTSN433/12TRG	10mm/10A	Yes	2.5	116	21	17.6	3.1	3.5	32
CTSN433/12WS	10mm/10A	No	4.0	116	21	17.3	Drill3.5	3.5	41
CTSN433/12S	10mm/10A	Yes	2.5	116	21	17.3	Drill3.5	3.5	32
CTSN433/12WQ	10mm/10A	No	4.0	116	21	17.0	3.1	3.5	41
CTSN433/12Q	10mm/10A	Yes	2.5	116	21	17.0	3.1	3.5	32

**Accessories****Strain relief clamp for terminal strips**

- Clamps external conductors in lighting fixtures according to EN 60598
- Natural colour PA6
- Takes the strain on the wires
- Prevents conductors from twisting
- Protects wire coating from abrasion and friction

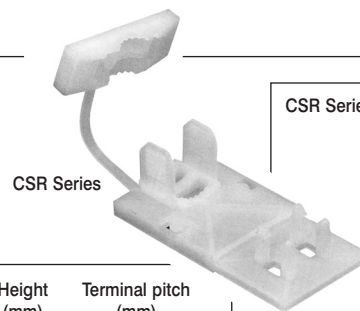

CSR Series

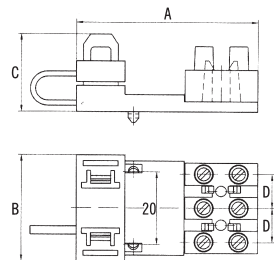

Type no.	Terminal strip	Length (mm)	Width (mm)	Height (mm)	Terminal pitch (mm)
CSR1	CTSN431	49.5	31	22.5	8
CSR2	CTSN433 and CTSN433T	52.5	31	22.5	10
CSR3	CTSN434	54.5	31	22.5	12

**Pluggable Terminal Strips Plug in****Features**

- Moulded from PA6
- White colour
- Easily cut to size
- Self extinguishing
- CE Approved
- Glow white test (EN60695) 960°C

Notes: Higher temperature and VO types available on request.

Available pre-cut to length for volume orders.

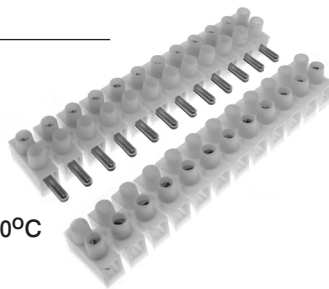
**Specification**

Voltage (max)	450Vac
Working temperature	85°C
No. of poles	12
Moulding	UL94-V2 Self-extinguishing PA 6
Conducting bush	Nickel Plated Brass
Screws	Plated Steel

Type No.	Max Section rigid	Max Section Flexible	Length	Width	Height	Fixing Holes	Insert diameter	Fixing hole pitch	Max Current
CTSN431/12M	2.5mm <sup>2</sup>	2.5mm <sup>2</sup>	94mm	16mm	15.5mm	2.75mm	2.9mm	8.0mm	17.5A
CTSN431/12F	2.5mm <sup>2</sup>	2.5mm <sup>2</sup>	94mm	16mm	15.5mm	2.75mm	2.9mm	8.0mm	17.5A
CTSN433/12M	6mm <sup>2</sup>	4mm <sup>2</sup>	119.4mm	20.5mm	16.4mm	3.2mm	3.4mm	10.25mm	24A
CTSN433/12F	6mm <sup>2</sup>	4mm <sup>2</sup>	119.4mm	20.5mm	16.4mm	3.2mm	3.4mm	10.25mm	24A
CTSN434/12M	10mm <sup>2</sup>	6mm <sup>2</sup>	143mm	23.5mm	19mm	3.5mm	4.3mm	12.3mm	57A
CTSN434/12F	10mm <sup>2</sup> A	6mm <sup>2</sup>	143mm	23.5mm	19mm	3.5mm	4.3mm	12.3mm	57A