

Nylon Terminal Strips 12 Way

Features

- Moulded from PA6 (standard), PA66 with glass fibre (grey) or PA66 (cream)
- Easily cut to size
- CE, cULus, & approvals
- Available with or without wire protection
- Self extinguishing
- Can be supplied pre-cut to specified number of poles
- Terminal strips can be printed on request
- V0 types pass 960°C glow-wire test
- Closed inserts (middle barrier) option
- Captive screws

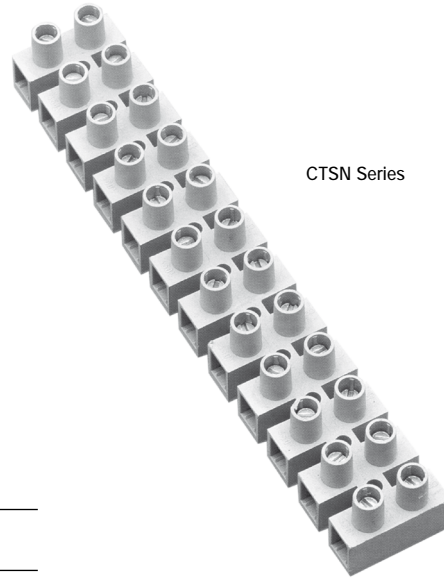

Specification

Voltage (max)	450V AC (Test voltage 2,500V) L types 750V (Test voltage 3,000V)
Working temperature	-30 to +110°C (PA6 and PA66) or -5 to +180°C (PA66+GF)
No. of poles	12
Moulding	UL94-V2 self extinguishing (PA6) or UL94-V0 (PA66 and PA66+GF)
Standard insert	Nickel-plated brass
Screws	Zinc-plated steel CQ-15 and metric thread
Wire protectors	Stainless steel

Type No.	Size	Wire Protector	Cable acceptance (mm)	Length A (mm)	Width B (mm)	Height C (mm)	Fixing holes (mm)	Insert diameter (mm)	Fixing hole pitch (mm)	Screw	Max current (A)
CTSN431/12W	8mm/6A	No	4.0	94	18	15.5	2.8	3	8	M3	17.5
CTSN431/12	8mm/6A	Yes	2.5	94	18	15.5	2.8	3	8	M3	17.5
CTSN433/12W	10mm/10A	No	4.0	116	21	16	3.1	3.2	10	M3	24
CTSN433/12	10mm/10A	Yes	2.5	116	21	16	3.1	3.2	10	M3	24
CTSN434/12W	12mm/16A	No	10.0	140	23	19	3.3	4	12	M3.5	32
CTSN434/12	12mm/16A	Yes	6.0	140	23	19	3.3	4	12	M3.5	32
CTSN435/12W	14mm/32A	No	16.0	166	29	23	3.4	6	14	M4	57
CTSN435/12	14mm/32A	Yes	10.0	166	29	23	3.4	6	14	M4	57
CTSN438/12W	18mm/64A	No	25.0	206	36	31	3.4	7.5	18	M5	76

Notes: Voltage and current rating vary with approvals. Part numbers shown are for standard PA6 material. For PA66 material change first digit to 5 (e.g. CTSN533/12). For PA66+GF change first digit to 6 (e.g. CTSN633/12).

CTSN Series



CTSN431/12W
CTSN433/12W
CTSN434/12W
CTSN435/12W
CTSN438/12W

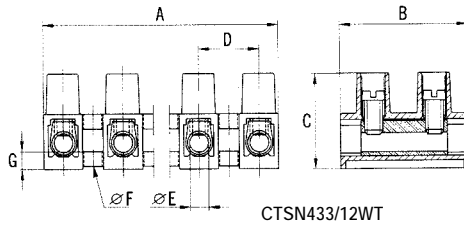

CTSN433/12WT

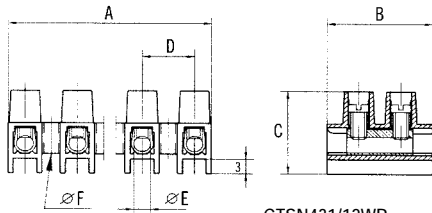

CTSN431/12WR
CTSN433/12WR
CTSN434/12WR
CTSN435/12WR

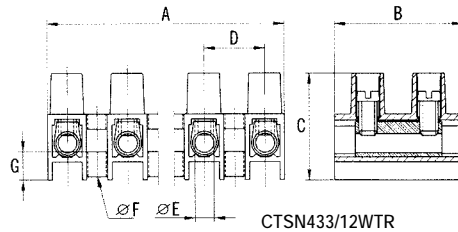

CTSN433/12WTR

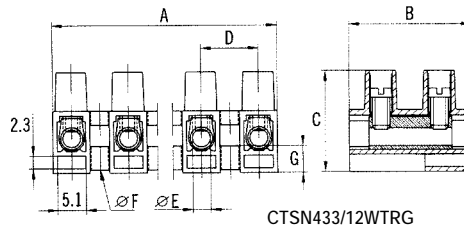

CTSN433/12WTRG

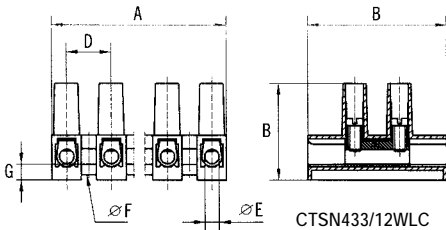

CTSN433/12WLC

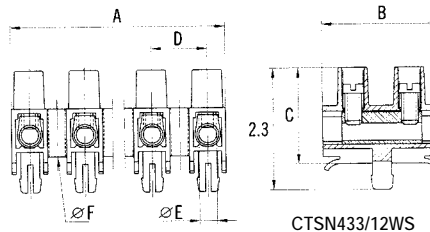

CTSN433/12WS

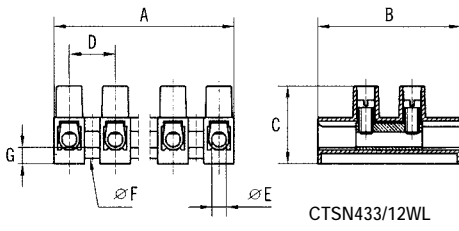

CTSN433/12WL

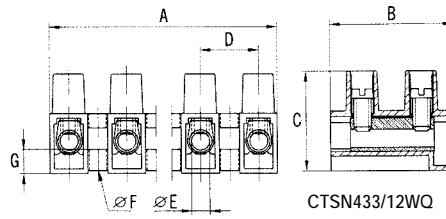

CTSN433/12WQ

Raised base types – provide increased isolation.

Type No.	Size	Wire Protector	Cable acceptance (mm)	Length A (mm)	Width B (mm)	Height C (mm)	Fixing holes (mm)	Insert diameter (mm)	Fixing hole pitch (mm)	Screw	Max current (A)
CTSN431/12WR	8mm/6A	No	4.0	94	18	17.2	2.8	3	8	M3	17.5
CTSN431/12R	8mm/6A	Yes	2.5	94	18	17.2	2.8	3	8	M3	17.5
CTSN433/12WR	10mm/10A	No	4.0	116	21	17.8	3.1	3.2	10	M3	24
CTSN433/12R	10mm/10A	Yes	2.5	116	21	17.8	3.1	3.2	10	M3	24
CTSN434/12WR	12mm/16A	No	10.0	140	23	20.5	3.3	4	12	M3.5	32
CTSN434/12R	12mm/16A	Yes	6.0	140	23	20.5	3.3	4	12	M3.5	32
CTSN435/12WR	14mm/32A	No	16.0	166	29	25.8	3.4	6	14	M4	57
CTSN435/12R	14mm/32A	Yes	10.0	166	29	25.8	3.4	6	14	M4	57

Special types

- CTSN433/12LC larger isolating surface per pole and screw tower Complies with EN60598/1 4.7 and 11.2
- CTSN433/12L larger isolating surface per pole (750V, test voltage 3,000V) Complies with EN60598/1 4.7 and 11.2
- CTSN433/12T fast fixing hole between poles
- CTSN433/12TR fast fixing hole between poles and raised base
- CTSN433/12TRG fast fixing hole between poles, raised base and socket in the base
- CTSN433/12S fixing pin (in any required position, maximum 8 pins)
- CTSN433/12Q fixing hole between poles and wide base terminal connection

Type No.	Size	Wire Protector	Cable acceptance (mm)	Length A (mm)	Width B (mm)	Height C (mm)	Fixing holes (mm)	Insert diameter (mm)	Fixing hole pitch (mm)	Screw	Max current (A)
CTSN433/12WLC	10mm/10A	No	4.0	117	31	21.5	3.5	3.2	3.2	10	M3 24
CTSN433/12LC	10mm/10A	Yes	2.5	117	31	21.5	3.5	3.2	3.2	10	M3 24
CTSN433/12WL	10mm/10A	No	4.0	117	31	16.8	3.5	3.2	3.2	10	M3 24
CTSN433/12L	10mm/10A	Yes	2.5	117	31	16.8	3.5	3.2	3.2	10	M3 24
CTSN433/12WT	10mm/10A	No	4.0	116	21	16	2.1	3.2	3.2	10	M3 24
CTSN433/12T	10mm/10A	Yes	2.5	116	21	16	2.1	3.2	3.2	10	M3 24
CTSN433/12WTR	10mm/10A	No	4.0	116	21	17.8	3.8	3.2	3.2	10	M3 24
CTSN433/12TR	10mm/10A	Yes	2.5	116	21	17.8	3.8	3.2	3.2	10	M3 24
CTSN433/12WTRG	10mm/10A	No	4.0	116	21	17.6	3.6	3.2	3.2	10	M3 24
CTSN433/12TRG	10mm/10A	Yes	2.5	116	21	17.6	3.6	3.2	3.2	10	M3 24
CTSN433/12WS	10mm/10A	No	4.0	116	21	17.3	-	Drill3.5	3.2	10	M3 24
CTSN433/12S	10mm/10A	Yes	2.5	116	21	17.3	-	Drill3.5	3.2	10	M3 24
CTSN433/12WQ	10mm/10A	No	4.0	116	21	17.0	3.0	3.2	3.2	10	M3 24
CTSN433/12Q	10mm/10A	Yes	2.5	116	21	17.0	3.0	3.2	3.2	10	M3 24

Accessories

Strain relief clamp for terminal strips

- Clamps external conductors in lighting fixtures according to EN 60598
- Natural colour PA6
- Takes the strain on the wires
- Prevents conductors from twisting
- Protects wire coating from abrasion and friction

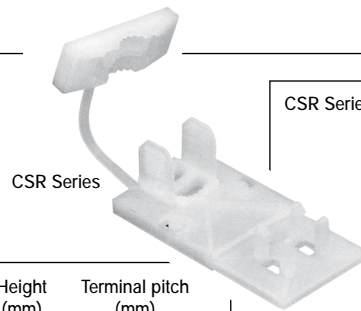

CSR Series

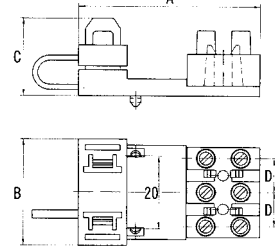

Type no.	Terminal strip	Length (mm)	Width (mm)	Height (mm)	Terminal pitch (mm)
CSR1	CTSN431	49.5	31	22.5	8
CSR2	CTSN433 and CTSN433T	52.5	31	22.5	10
CSR3	CTSN434	54.5	31	22.5	12

Pluggable Terminal Strips Plug in

Features

- Moulded from PA6
- White colour
- Easily cut to size
- Self extinguishing
- CE approved

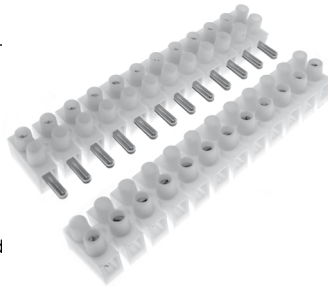

Notes: UL94-VO (160°C) flame retard version available on request.
Available pre-cut to length for volume

Specification

Voltage (max)	450Vac
Working temperature	85°C
Short period	110°C
No. of poles	12
Moulding	UL94-V2 Self-extinguishing Polyamide 6
Conducting bush	Brass
Screws	6µ Zinc, colour passivated and tropicalised

Type No.	Size	Length	Width	Height	Fixing Holes	Insert diameter	Fixing hole pitch	Screw	Max Current
CTSN431/12M	8mm/6A	94.8mm	16mm	15.3mm	2.5mm	2.9mm	8.0mm	M3	17.5A
CTSN431/12F	8mm/6A	94.8mm	16mm	15.3mm	2.5mm	2.9mm	8.0mm	M3	17.5A
CTSN433/12M	10mm/10A	119mm	20.3mm	16.4mm	3.2mm	3.4mm	10.0mm	M3	24A
CTSN433/12F	10mm/10A	119mm	20.3mm	16.4mm	3.2mm	3.4mm	10.0mm	M3	24A
CTSN434/12M	12mm/16A	141.9mm	23.2mm	19.2mm	3.3mm	4.3mm	12.0mm	M3.5	57A
CTSN434/12F	12mm/16A	141.9mm	23.2mm	19.2mm	3.3mm	4.3mm	12.0mm	M3.5	57A