

## 10mm Pitch Commercial Standard Profile Screw Terminal

- 1 Pole in 10mm & 15mm length
- 1-12 pole solid block
- Moulded in grey UL94-V0 flame retardant Lexan
- Wire protector terminals
- 4mm<sup>2</sup> cable entry
- approved
- Guided pin alignment
- Captive screws
- Anti solder wicking terminals

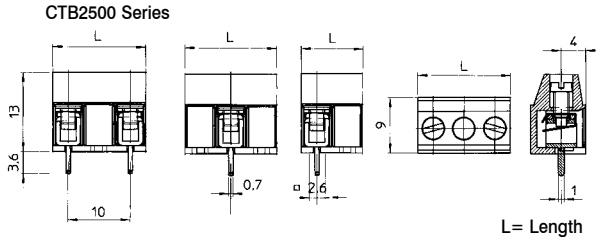

Type No.	Poles	Length
CTB2500/2	2	15mm
CTB2500/3	3	25mm
CTB2500/4	4	35mm
CTB2500/5	5	45mm



Rating	24A/500V, UL=18A, CUL=18A, IMQ=24A, VDE=24A
Dielectric strength	≥2.5kV
Impulse withstand voltage	6kV
Working temperature	85°C
Moulding	UL94-V0 flame retardant Lexan
Pin/terminal	Tinned, nickel plated brass
Wire protector	Tin plated phosphor bronze
Screw/torque	M3 steel, zinc colour plated/0.5Nm
Recommended PCB hole size	ø1.3mm

## 10mm Pitch 18 Pole Rising Clamp Terminal

- Unique 18 pole strip
- Easily cut to required number of poles
- Can be supplied pre-cut
- 1 pole in 10mm & 15mm length
- Moulded in grey UL94-V0 flame retardant Lexan
- Professional rising clamp terminals
- 4mm<sup>2</sup> cable entry
- approved
- Guided pin alignment
- Captive screws
- Anti solder wicking terminals



Type No.	Poles	Length
CTB8000/1	1	10mm
CTB8000/1/15	1	15mm
CTB8000/2	2	15mm
CTB8000/3	3	25mm
CTB8000/4	4	35mm
CTB8000/5	5	45mm
CTB8000/6	6	55mm
CTB8000/7	7	65mm
CTB8000/8	8	75mm
CTB8000/9	9	85mm
CTB8000/10	10	95mm
CTB8000/11	11	105mm
CTB8000/12	12	115mm
CTB8000/18	18	175mm

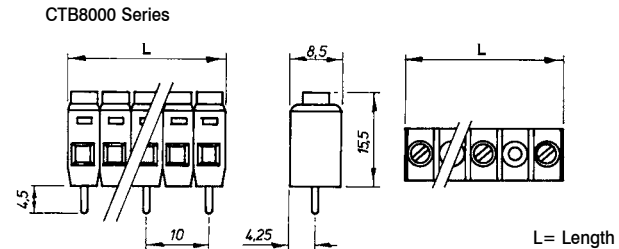

Rating	17.5A/750V, UL=16A, CUL=16A, IMQ=22A, VDE=22A
Dielectric strength	≥3kV
Impulse withstand voltage	6kV
Working temperature	85°C
Moulding	UL94-V0 flame retardant Lexan
Pin/terminal	Tinned, nickel plated brass
Rising clamp	Zinc plated steel
Screw/torque	M2.5 steel, zinc colour plated/0.4Nm
Recommended PCB hole size	ø1.3mm