

### 5mm Pitch Low Profile Screw Terminal

- 2 & 3 pole interlocking CTB5000
- 4-12 pole solid block end stackable
- Test probe facility
- Moulded in grey UL94-V0 flame retardant Lexan
- Wire protector terminals
- 1.5mm<sup>2</sup> cable entry
-  approved
- Guided pin alignment
- Anti solder wicking terminal

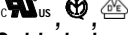
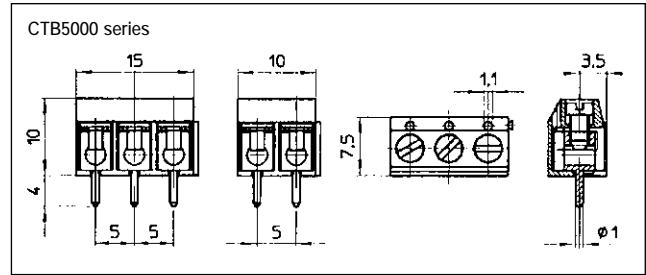

Type No.	Poles	Length
CTB5000/2	2	10mm
CTB5000/3	3	15mm
CTB5000/4	4	20mm
CTB5000/5	5	25mm
CTB5000/6	6	30mm
CTB5000/7	7	35mm
CTB5000/8	8	40mm
CTB5000/9	9	45mm
CTB5000/10	10	50mm
CTB5000/11	11	55mm
CTB5000/12	12	60mm

#### Specification

Rating	13.5/200V, UL=14A, CUL=14A, IMQ=13.5A, VDE=13.5A
Dielectric strength	≥2kV
Working temperature	85°C
Impulse withstand voltage	6kV
Moulding	UL94-V0 flame retardant Lexan
Pin/terminal	Tinned, nickel plated brass
Wire protector	Tin plated phosphor bronze
Screw/torque	M2.5 steel, zinc plated 0.4Nm
Recommended PCB hole size	ø1.1mm

### 5mm Pitch Low Profile 90° Screw Terminal

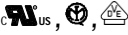
- 2 & 3 pole interlocking CTB5050
- 4-12 pole pre-assembled
- Test probe facility
- 90° Mounting
- Moulded in grey UL94-V0 flame retardant Lexan
- Wire protector terminals
- 1.5mm<sup>2</sup> cable entry
-  approved
- Anti solder wicking terminal
- Guided pin alignment

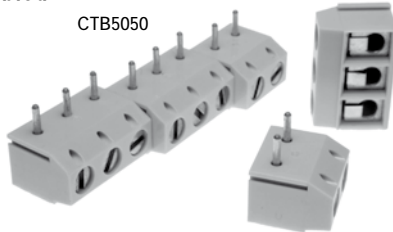

Type No.	Poles	Length
CTB5050/2	2	10mm
CTB5050/3	3	15mm
CTB5050/4	4	20mm
CTB5050/5	5	25mm
CTB5050/6	6	30mm
CTB5050/7	7	35mm
CTB5050/8	8	40mm
CTB5050/9	9	45mm
CTB5050/10	10	50mm
CTB5050/11	11	55mm
CTB5050/12	12	60mm

#### Specification

Rating	13.5/200V, UL=14A, CUL=14A, IMQ=13.5A, VDE=13.5A
Dielectric strength	≥2kV
Impulse withstand voltage	6kV
Working temperature	85°C
Moulding	UL94-V0 flame retardant Lexan
Pin/terminal	Tinned, nickel plated brass
Wire protector	Tin plated phosphor bronze
Screw/torque	M2.5 steel, zinc plated /0.4Nm
Recommended PCB hole size	ø1.1mm

