



Push-in Fast Connectors

Features

- Fast connection/disconnection on both appliance and installation sides
- Moulded from PA66 (beige)
- Self extinguishing
- 2 to 5 poles
- Three different types of earth
- With or without fixing pins
- Terminal marking available on request
- CE,  &  approvals

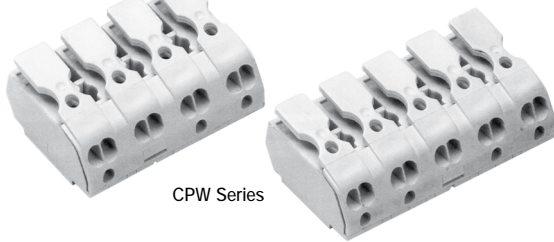

Specification

Voltage (max)	450V AC
Working temperature	-5 to +85°C
No of poles	2, 2+E, 3+E or 4+E
Moulding	UL94-V2 self extinguishing PA66
Insert strap	Strapping steel
Insert	Steel and copper
Marking	Standard and custom markings available
Isolation wire length:	- wires from 0.5 to 1.0mm_: 8 to 9mm - wires from 1.5 to 2.5mm_: 9 to 10mm - capacitor: 9 to 11mm
	Test current: 24A

Rated connecting capacity

Models	Appliance side	Capacitor	Installation side
Rated connecting capacity	1 x 2.5_ and 1 x 1.5mm	0.75mm_	2 x 2.5mm_
Conductor's minimum section (mm_)	0.75	0.5	1.0

CPW series

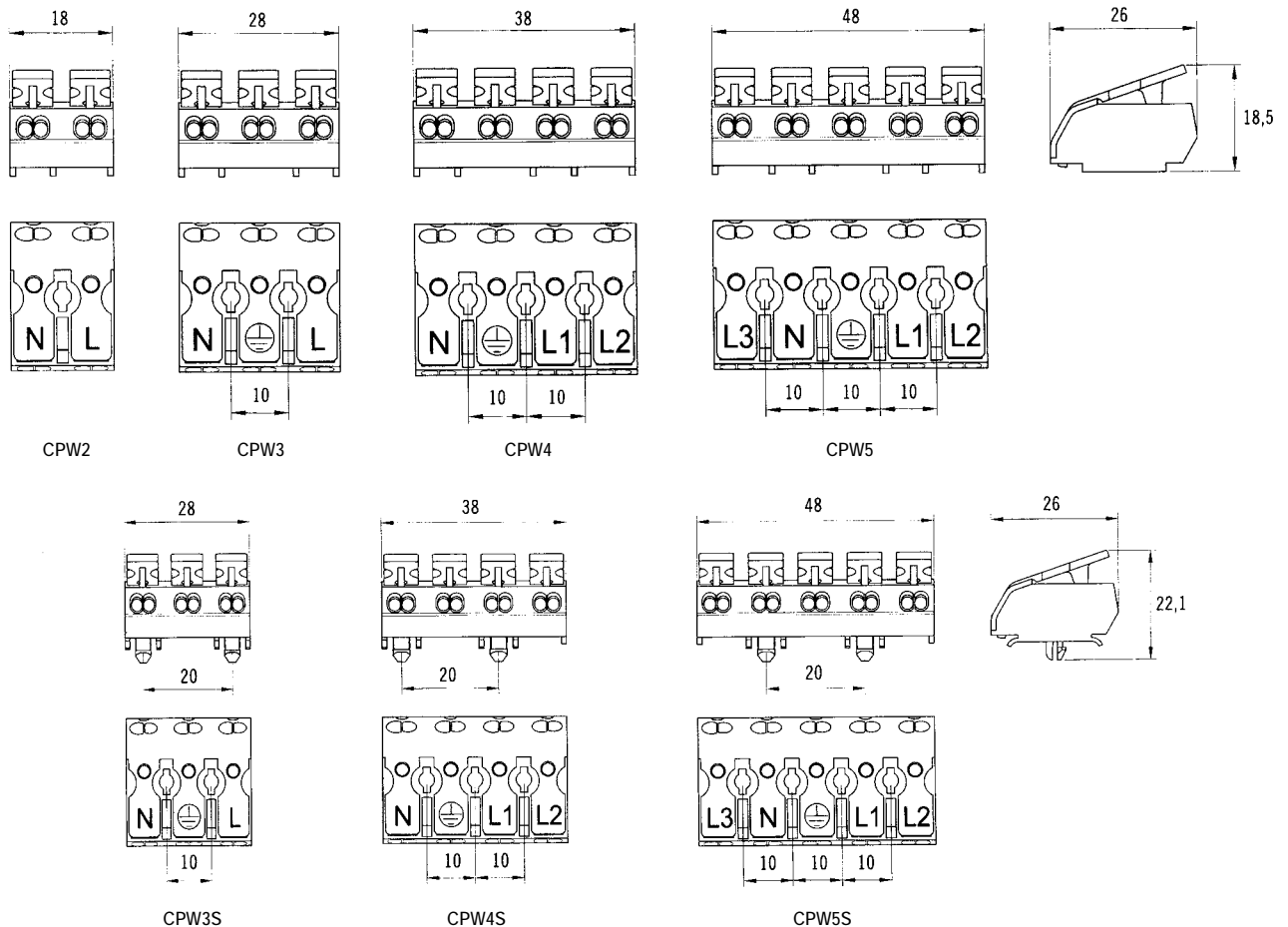

CPW series

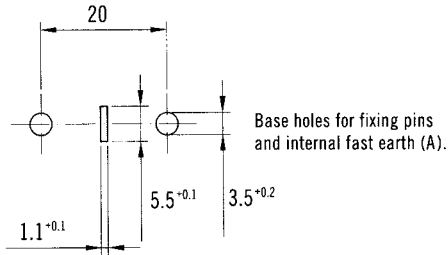
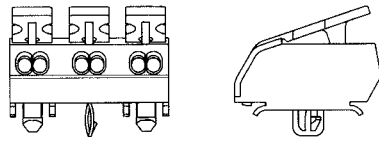

Base thickness: Max.1 mm.

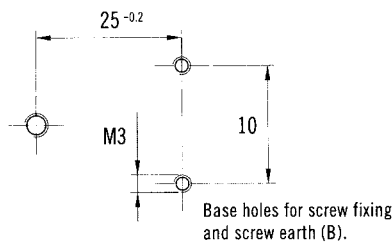
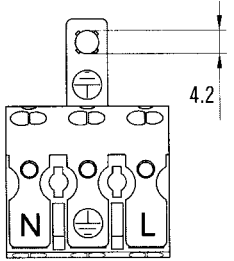
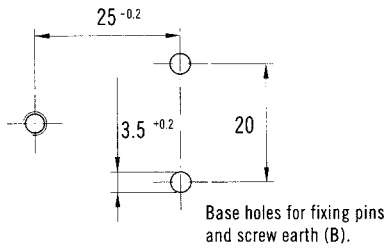
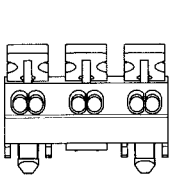

Base thickness: Max.1 mm.

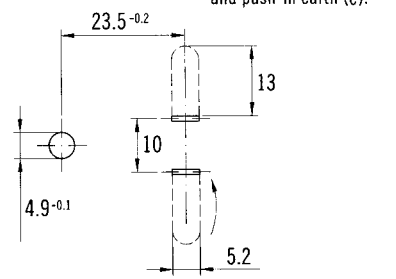
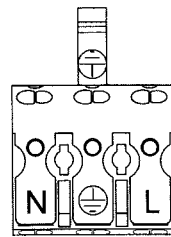
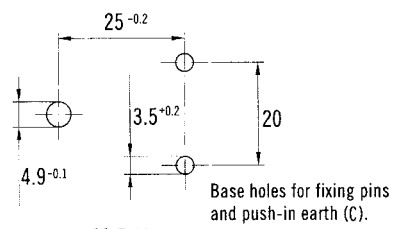
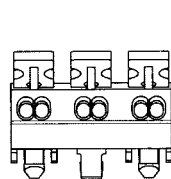

Base thickness: Max.1 mm.

Number of poles	Without fixing pins				With fixing pins (A)			
	Without earthing	Earth A	Earth B	Earth C	Without earthing	Earth A	Earth B	Earth C
2	CPW2	-	-	-	-	-	-	-
3(2+T)	CPW3	CPW3A	CPW3B	CPW3C	CPW3S	CPW3SA	CPW3SB	CPW3SC
4(3+T)	CPW4	CPW4A	CPW4B	CPW4C	CPW4S	CPW4SA	CPW4SB	CPW4SC
5(4+T)	CPW5	CPW5A	CPW5B	CPW5C	CPW5S	CPW5SA	CPW5SB	CPW5SC

Accessories

Strain relief clamp for terminal strips

