

CISB Isolated Strips and Blocks

Features

- Enables connecting of additional wires without cutting main conductor
- Capacity from 2x6mm² to 2x150mm²
- Up to 35mm² supplied as 12 pole, easily divided
- 50mm² and above supplied singly, easily joined
- Raised screws
- 50mm² and above available with Allen screws
- CE approved

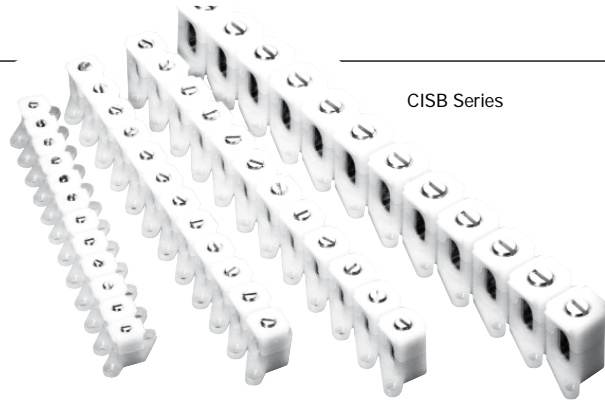

Specification

Voltage	500V
Working temperature	-5°C body, 100°C inserts
Moulding	Natural PA6 UL94-V2
Insert	Nickel-plated brass
Screws	Zinc-plated brass

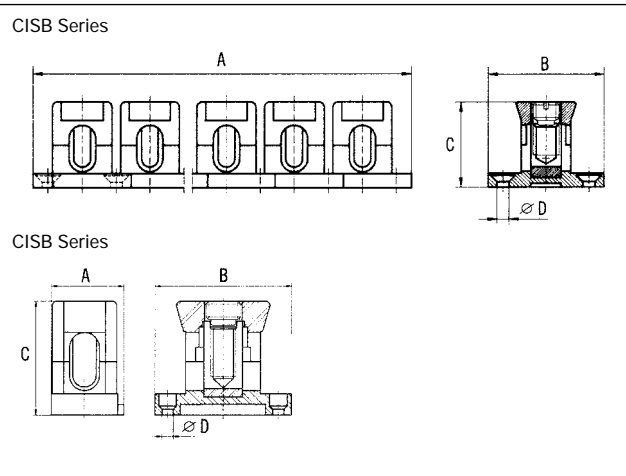

Type No.	Poles	Length A	Width B	Height C	Fixing dia D	Screw	Allen	Current	Capacity	
									Min.	Max.
CISB6	12	188	29	17	3.2	M5		41A	2x2.5mm ²	2x6mm ²
CISB10	12	224	31	23	3.2	M7		57A	2x4mm ²	2x10mm ²
CISB16	12	260	32	26	3.2	M8		76A	2x6mm ²	2x16mm ²
CISB35	12	308	36	34	3.2	M12		125A	2x16mm ²	2x35mm ²
CISB50	1	32	63	48	5	M14	5	125A	2x25mm ²	2x50mm ²
CISB70	1	34	63	53	5	M16	6	160A	2x35mm ²	2x70mm ²
CISB95	1	39	63	56	5	M18	8	232A	2x50mm ²	2x95mm ²
CISB120	1	41	70	61	5	M20	8	269A	2x70mm ²	2x120mm ²
CISB150	1	52	115	82	5	M28	14	309A	2x95mm ²	2x150mm ²

N.B. for optional allen screw add suffix /A e.g. CISB120/A

